

EDGE APPLICATION

BASE CASE

RESULTS	Final Energy Use 86,676.22 kWh/Month	Operational CO ₂ Savings -0.77 tCO ₂ /Year	Base Case Utility Cost 137,806.61 Thousand Rp/...	Incremental Cost 180.63 Thous...
	Final Water Use 1,056.68 m ³ /Month	Embodied Energy Savings 0.08 MJ/m ²	Utility Cost Reduction -152.00 Thousand Rp/...	Payback in Years N/A Yrs.

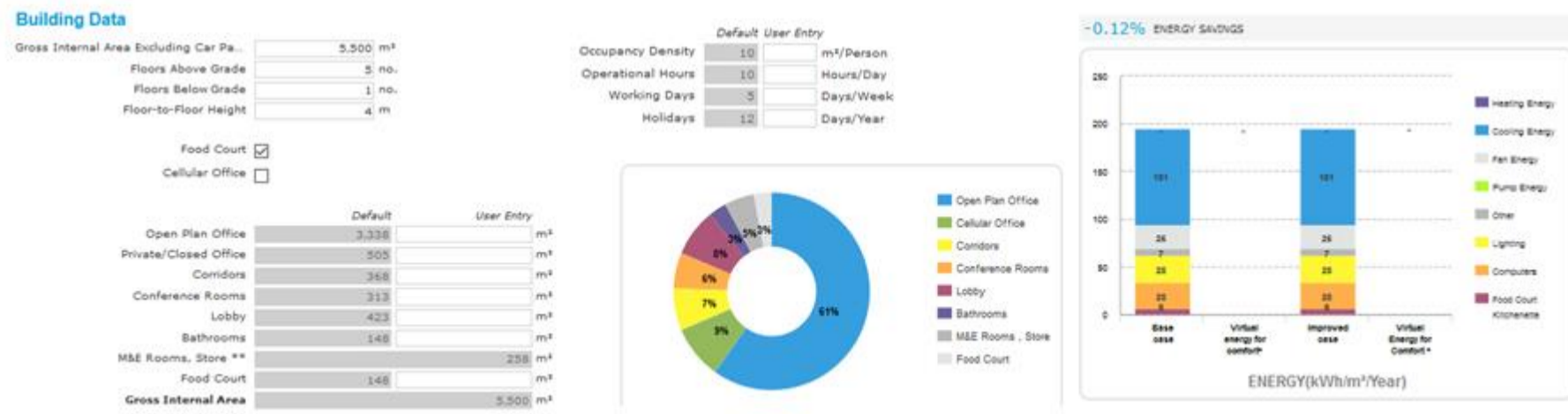

FANIAH SHAFIRA A I /
08111850070007

ALTERNATIF 1

RESULTS	Final Energy Use 38,870.84 kWh/Month	Operational CO ₂ Savings 429.90 tCO ₂ /Year	Base Case Utility Cost 149,684.61 Thousand Rp...	Incremental Cost 220,427.29 Thous...
	Final Water Use 787.05 m ³ /Month	Embodied Energy Savings 1,233.75 MJ/m ²	Utility Cost Reduction 87,298.46 Thousand Rp...	Payback in Years 0.21 Yrs.

60.25% Meets EDGE Energy Standard

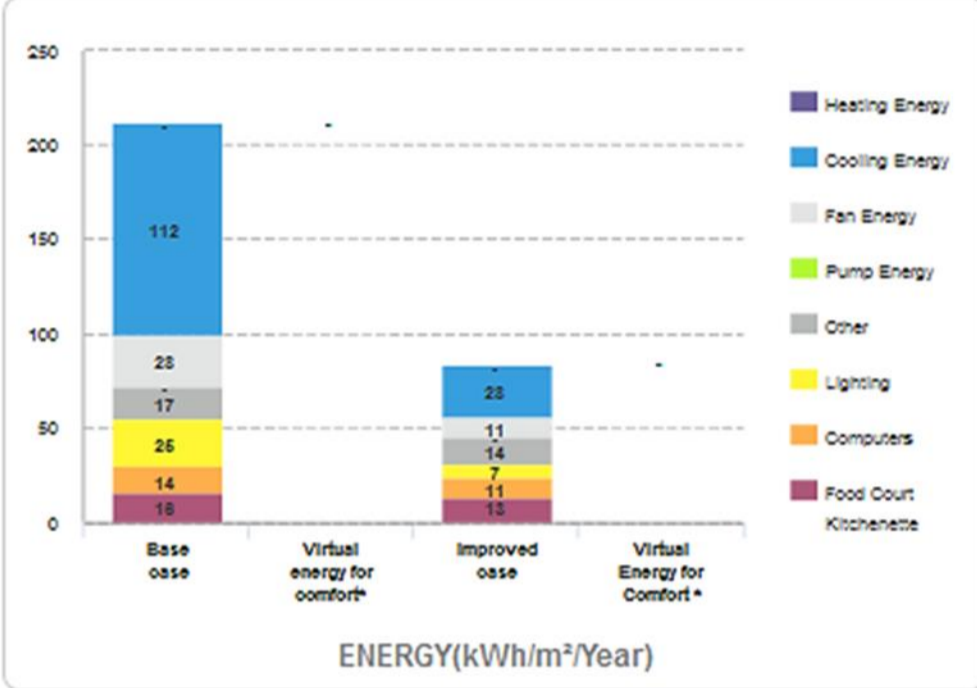

25.52% Meets EDGE Water Standard

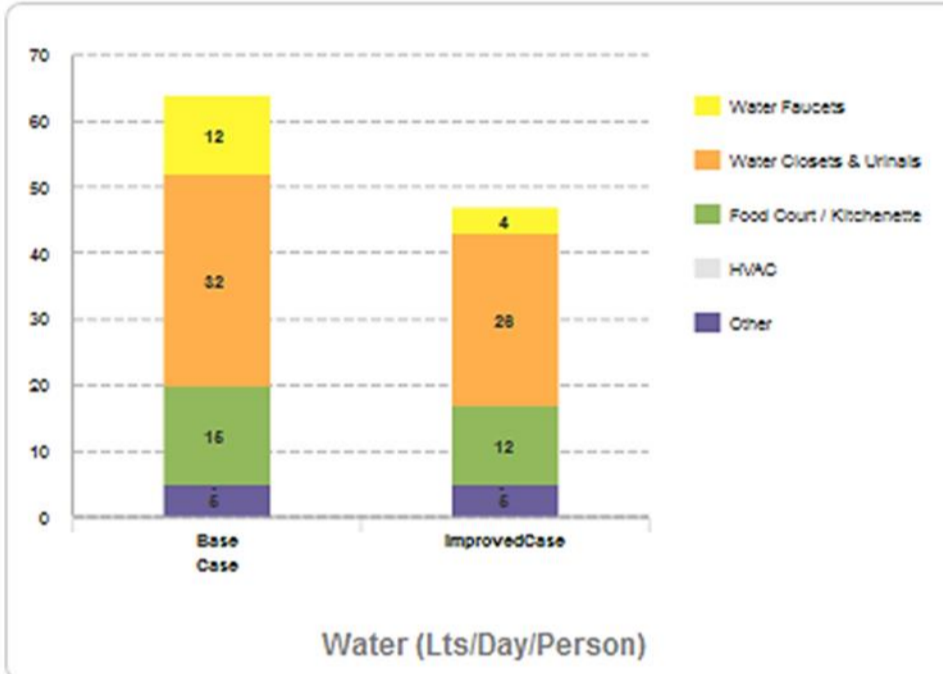

44.43% Meets EDGE Material Standard

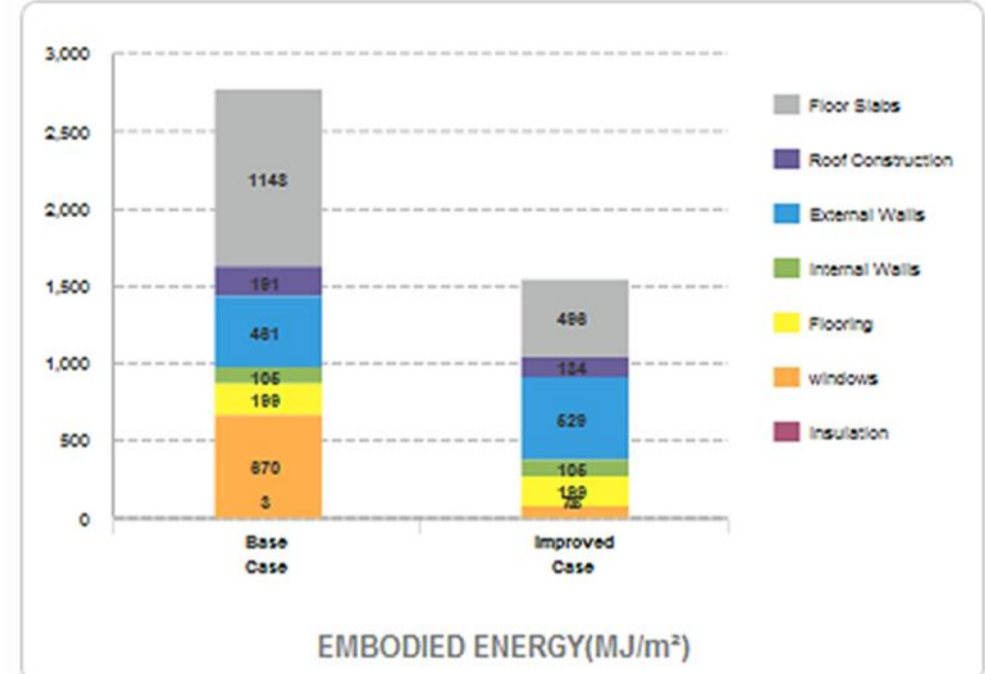

ALTERNATIF 1

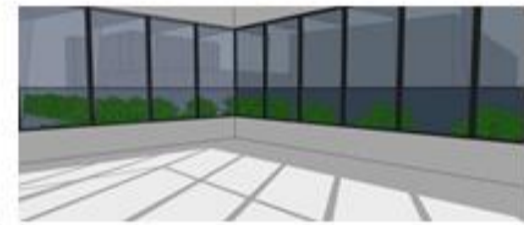
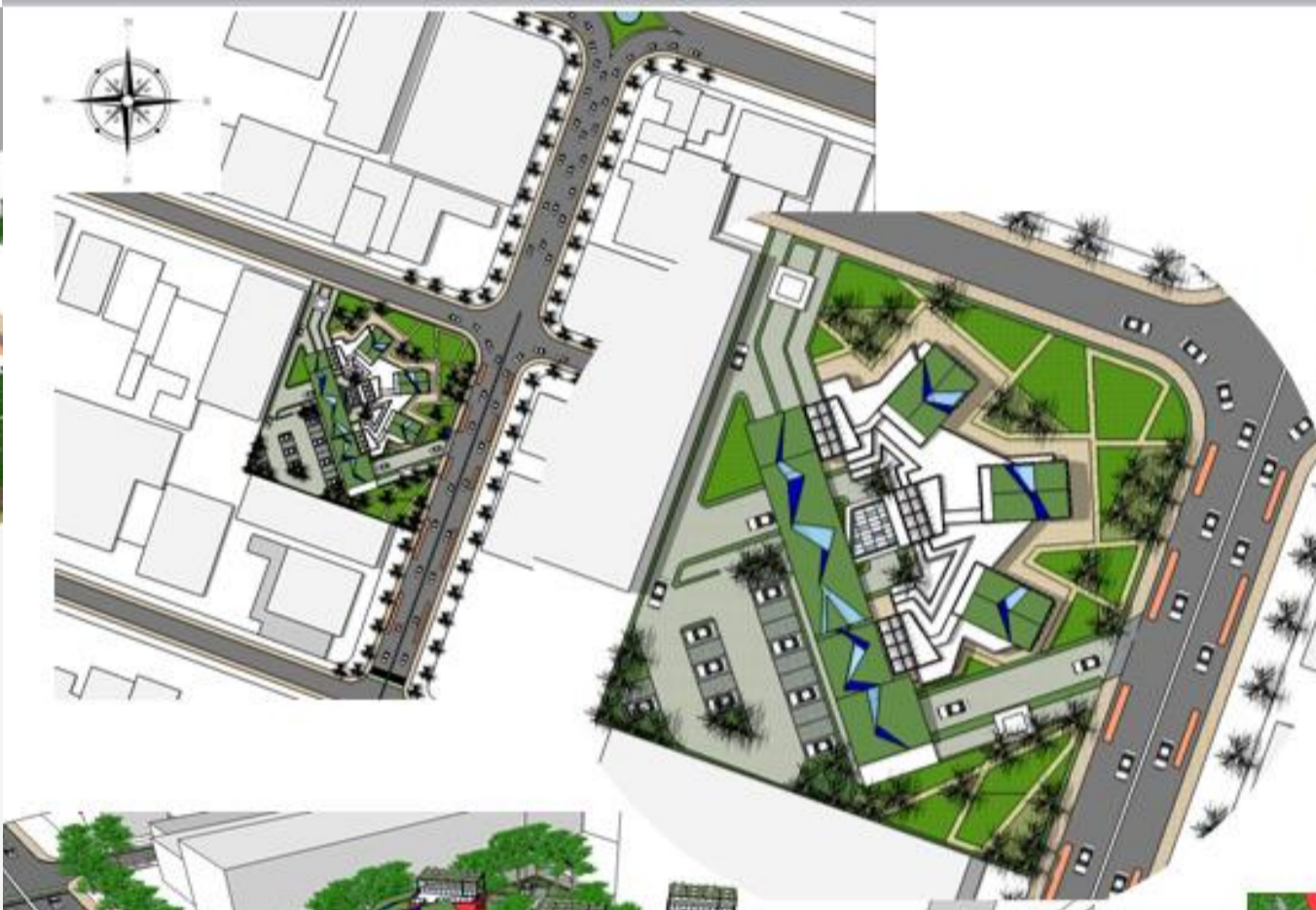

Penggunaan shading devices dengan pattern tertentu untuk menangkap cahaya matahari ke dalam ruang



Pemanfaatan view untuk pemecahan bentuk dan fasad

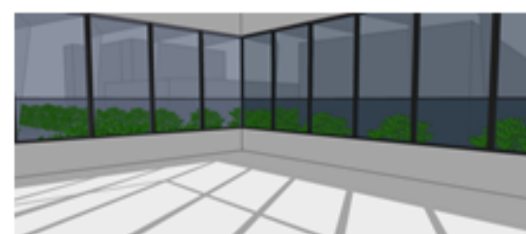

View di luar bangunan jika dilihat dari dalam bangunan

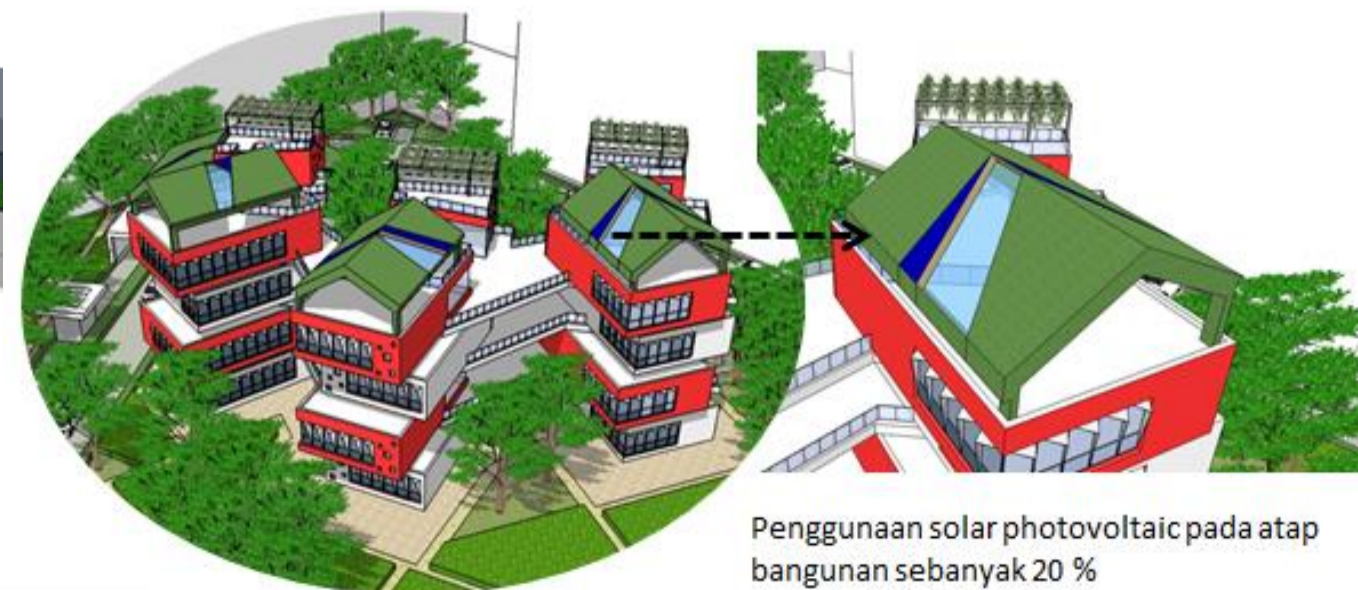

Penggunaan solar photovoltaic pada atap bangunan sebanyak 20 %



EDGE APPLICATION

BASE CASE

RESULTS	Final Energy Use 89,870.27 kWh/Month	Operational CO ₂ Savings -0.77 tCO ₂ /Year	Base Case Utility Cost 137,809.61 Thousand Rp/...	Incremental Cost 180.93 Thous...
	Final Water Use 1,050.60 m ³ /Month	Embodied Energy Savings 0.66 MJ/m ²	Utility Cost Reduction -152.96 Thousand Rp/...	Payback in Years N/A Yrs.

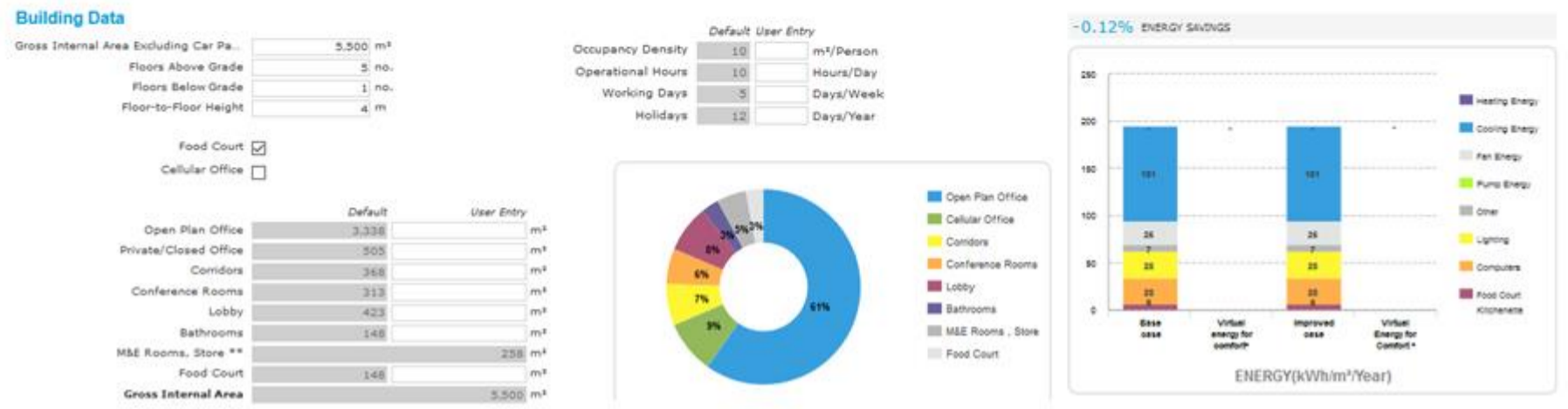

FANIAH SHAFIRA A I /
08111850070007

ALTERNATIF 2

RESULTS	Final Energy Use 48,588.56 kWh/Month	Operational CO ₂ Savings 358.99 tCO ₂ /Year	Base Case Utility Cost 149,684.61 Thousand Rp...	Incremental Cost 139,180.76 Thous...
	Final Water Use 787.05 m ³ /Month	Embodied Energy Savings 1,233.75 MJ/m ²	Utility Cost Reduction 73,248.46 Thousand Rp...	Payback in Years 0.16 Yrs.

50.31% Meets EDGE Energy Standard

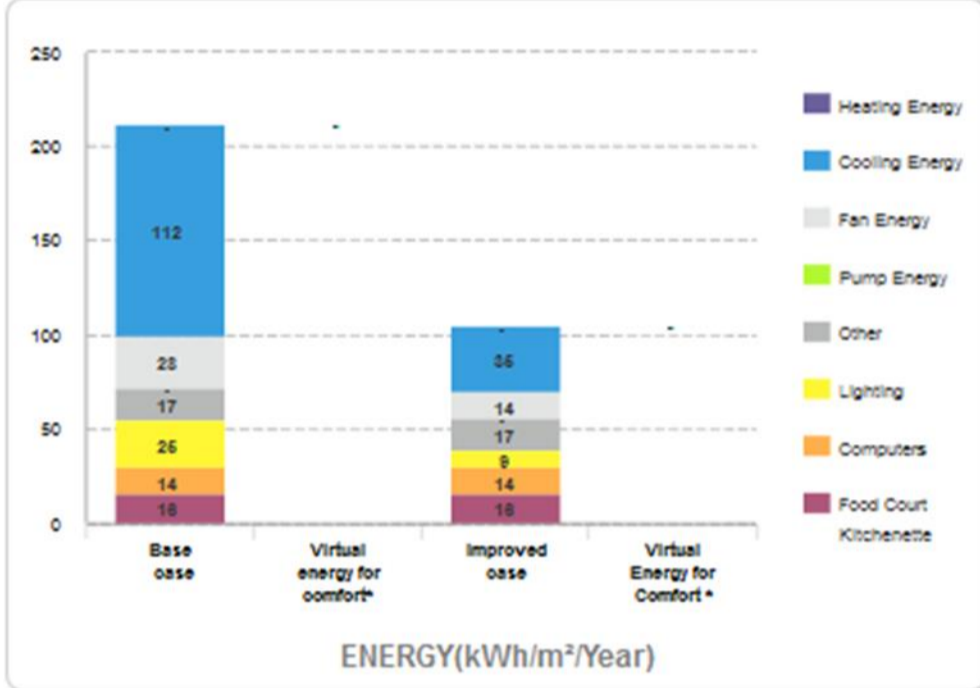

25.52% Meets EDGE Water Standard

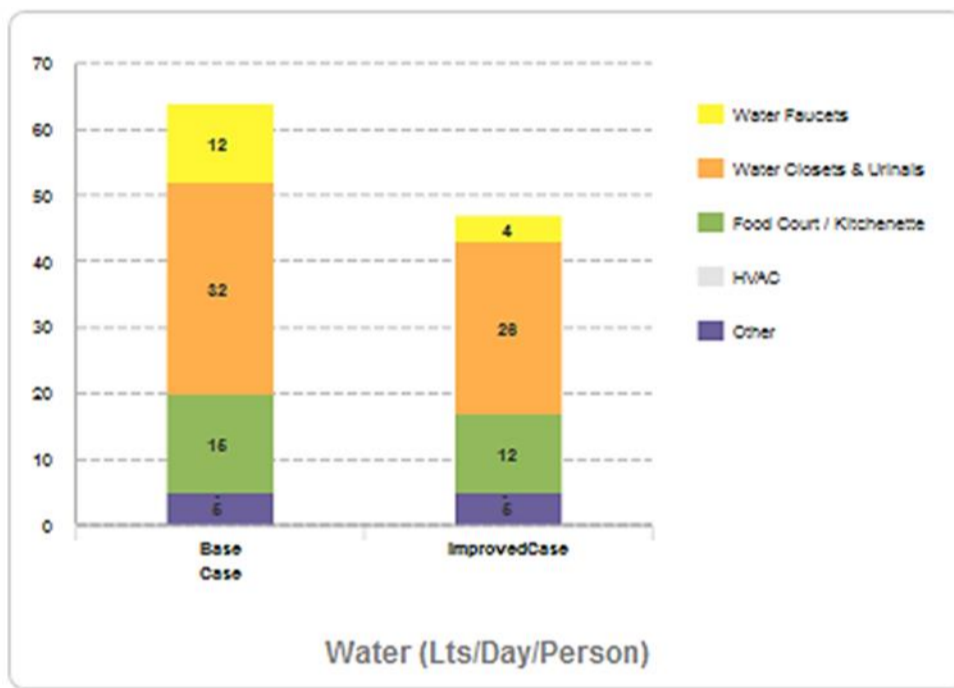

44.43% Meets EDGE Material Standard

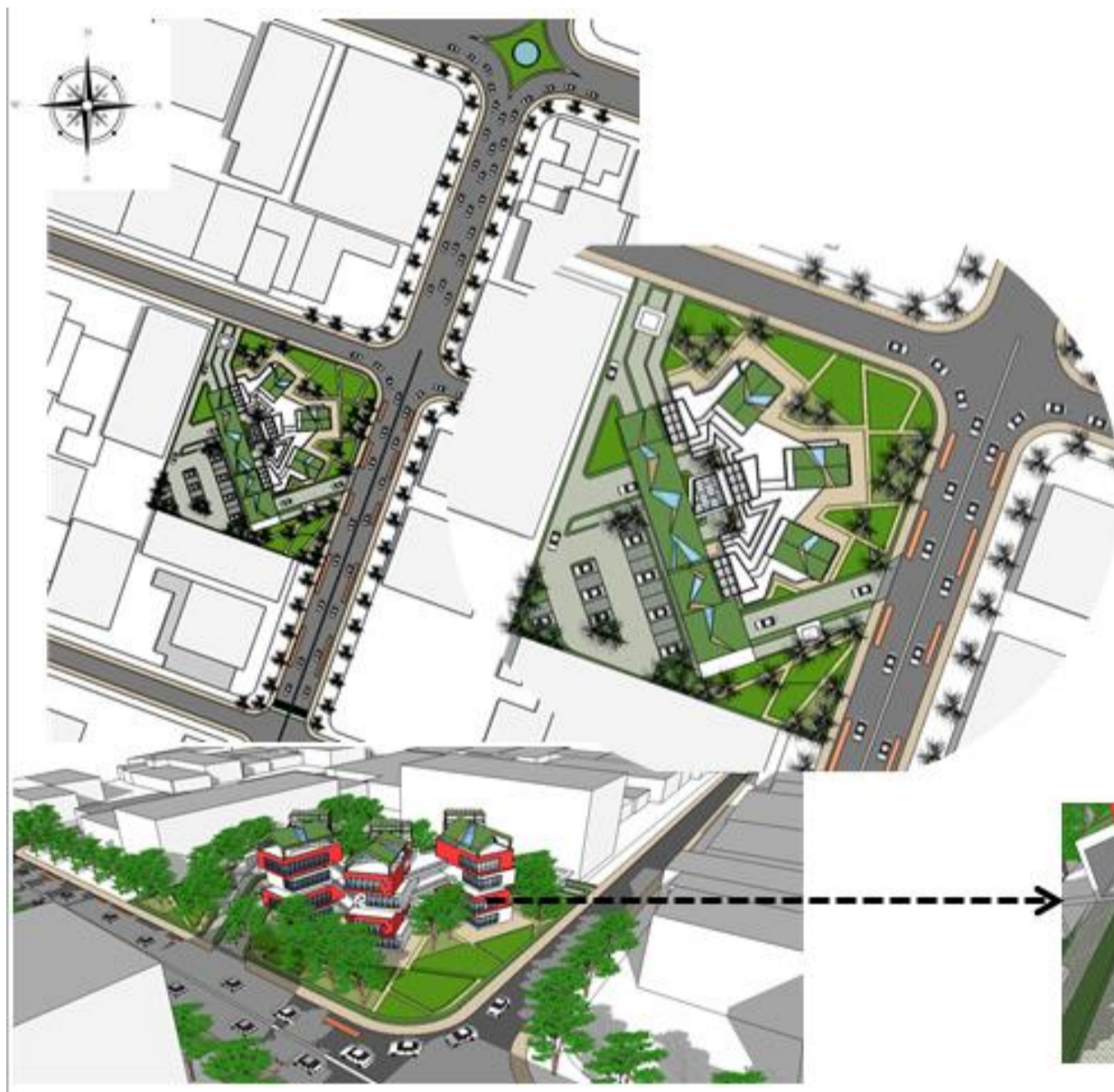
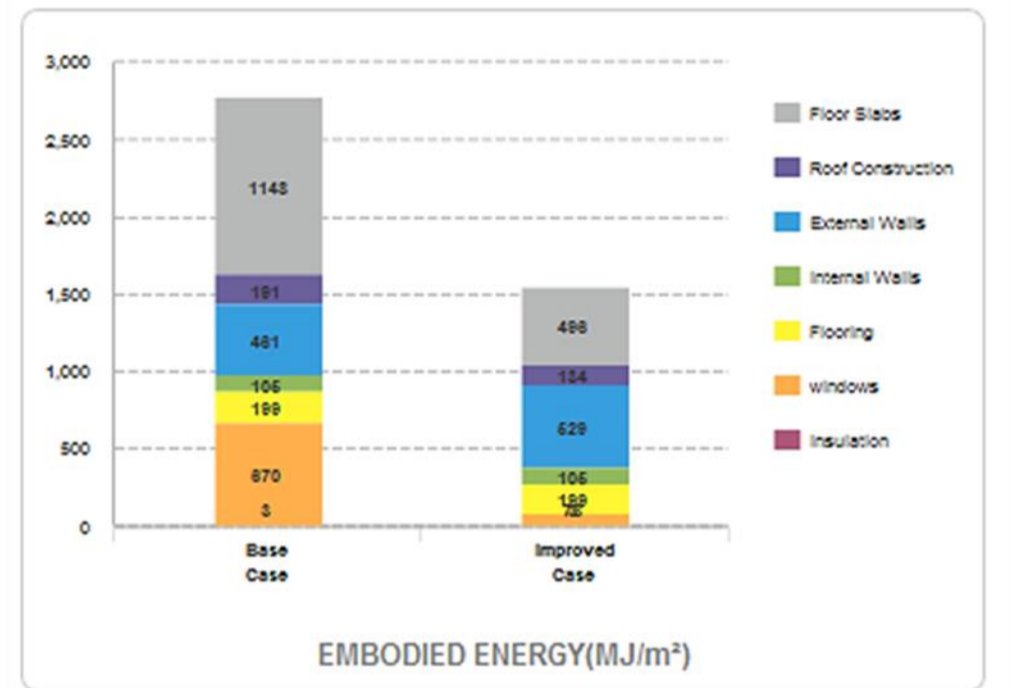

ALTERNATIF 2

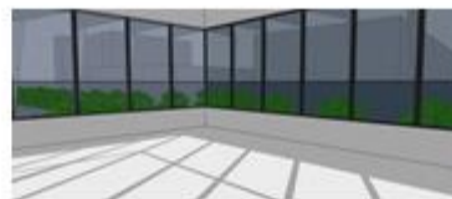

Penggunaan shading devices dengan pattern tertentu untuk menangkap cahaya matahari ke dalam ruang



Pemanfaatan view untuk pemecahan bentuk dan fasad

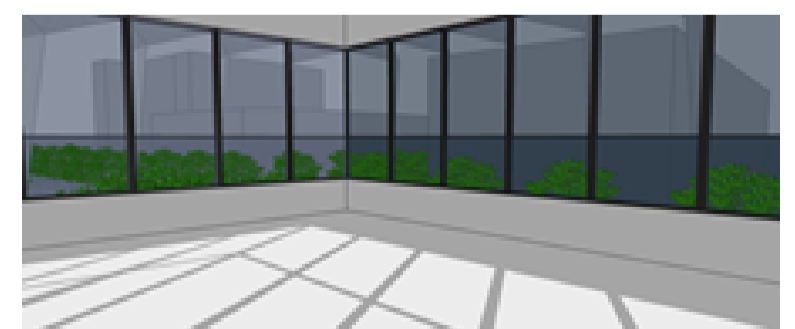

View di luar bangunan jika dilihat dari dalam bangunan

